

Mounting Detail
MOUNTS TO J-BOX

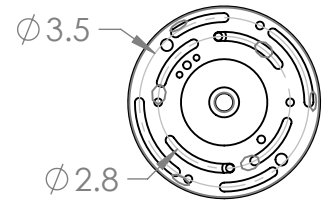
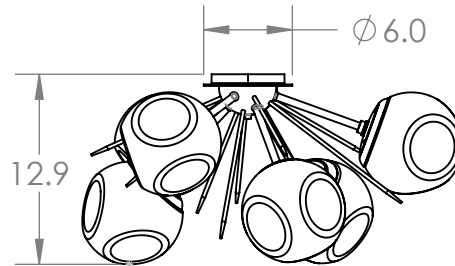

MINIMUM SIZE OF J-BOX REQUIRED IS
4" L x 4" W x 1.5" H

PRODUCT DESCRIPTION

This sputnik-style flush mount elevates a familiar silhouette with a fresh modern update to the traditional round glass shade. Softly undulant orbs of handblown crystal glass enclose an LED-illuminated cast crystal glass diffuser in a choice of three styles. Choose from several glass colors and finishes

PRODUCT SPECIFICATION

Construction: Steel Body & Rods, Blown Glass with Cast Glass Diffuser

Finish Options: BS MB FB GB CS GP BB NB

Glass Options: A B C S

Suspension Method: Ceiling Mount

Weight (lbs.): 27

UL Rating: Indoor/Dry

Top Diffuser: Closed Glass

Bottom Diffuser: Closed Glass

Light Source: LED

Electrical Qty: 6

Wattage (Watts): 15.5

Voltage (Volts): 120

Source Lumens: 1399

Dimming: Forward/Reverse Phase to 1%

CCT: 2700k or 3000K

Driver Quantity & Location: 1, In J-Box

CRI: 93+

Power Factor: >0.9

SCAN FOR MORE
INFORMATION



GENERAL NOTES:

All dimensions are shown in inches unless otherwise stated. Visit studio.hammerton.com to read about our Lifetime Limited Warranty. This product may use mixed materials like steel and aluminum in its construction. Transparent finishes may vary between steel and aluminum. Hammerton products are made by artisans, not machines. A close inspection may reveal subtle variations and imperfections in glass, metal and other handcrafted materials that reflect the mark of the maker. They should be expected and celebrated.

© Copyright 2024. All rights in design, detail or invention of this drawing are reserved as the property of Hammerton. Any imitation or adaptation without written consent is strictly prohibited. Hammerton Inc. 217 Wright Brothers Dr. Salt Lake City, UT 84116 (801)973-8095 | studio.hammerton.com | info@hammerton.com