

TETRO

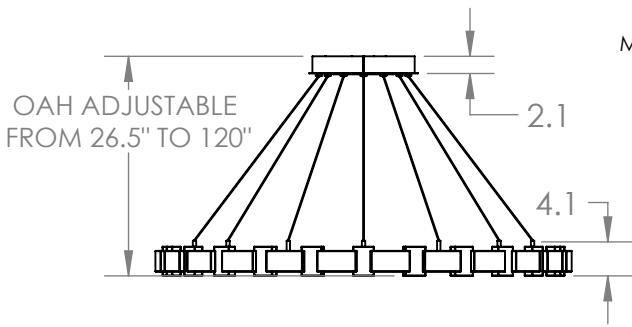

PAVE



Mounting Detail  
MOUNTS TO BUILDING STRUCTURE

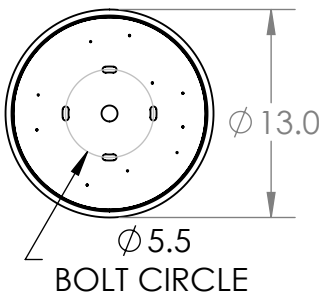

PRODUCT DESCRIPTION

The 2,500-year old art of glass mosaic tiling is brilliantly brought to light in the TESSERA 38in Ring. TESSERA lighting features a choice of two tile motifs in artisan cast crystal glass and is illuminated with 93+ CRI integrated LED.

PRODUCT SPECIFICATION

- Construction: Steel Body With Cast Glass, Suspended By Cable
- Finish Options: BS MB FB GB CS GP BB NB SN GM RB HB
- Glass Options: Clear Cast Glass
- Suspension Method: Ceiling Mount
- Weight(lbs.): 141 lbs
- UL Rating: Indoor/Dry
- Top Diffuser: Closed, Metal
- Bottom Diffuser: Closed, Frosted Acrylic
- Light Source: LED
- Electrical Qty: 7
- Wattage (Watts):86
- Voltage (Volts): 120
- Source Lumens: 6656
- Dimming: Forward/Reverse Phase to 1%
- CCT: 3000K
- Driver Quantity & Location: 3, In Canopy
- CRI: 93+
- Power Factor: >0.9

SCAN FOR MORE  
INFORMATION

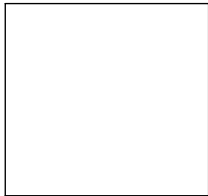

**GENERAL NOTES:**  
All dimensions are shown in inches unless otherwise stated.  
Visit [studio.hammerton.com](https://studio.hammerton.com) to read about our Lifetime Limited Warranty.  
This product may use mixed materials like steel and aluminum in its construction. Transparent finishes may vary between steel and aluminum.  
All Hammerton fixtures are handcrafted by artisans. Subtle imperfections reflect the mark of the artisan and should be expected in any handcrafted product. Dimensions may vary up to 7/8".  
© Copyright 2022. All rights in design, detail or invention of this drawing are reserved as the property of Hammerton. Any imitation or adaptation without written consent is strictly prohibited.  
Hammerton Inc. 217 Wright Brothers Dr. Salt Lake City, UT 84116 (801)973-8095 | [studio.hammerton.com](https://studio.hammerton.com) | [info@hammerton.com](mailto:info@hammerton.com)